

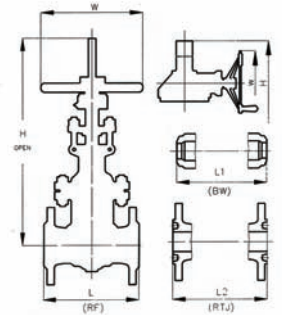

SUFA

ANSI Cast Steel valves

Gate		Tipo : Class 150
Carbon steel - Class 150 Bolted Bonnet - Flanged RF/RTJ & BW		
Applications: Valves used in Oil refining, Petrochemical, Chemical, Metallurgy, Paper making and Pharmaceutical industries		
<ul style="list-style-type: none"> * OS&Y * Rising stem * Flexible solid wedge * Bolted bonnet * Threaded or welded seat ring 		
Specifications		
Type	:	Class 150
Material	:	Body :ASTM A216 WCB (*) Trim:F6 U, XU, etc. Body/bonnet gasket:Graphite
Construction	:	API 600
Flanged	:	2" up to 24" ANSI B16.5. 26" up to 36" acc. to ASME B16.47 series A (MSS SP-44). ASME B16.47 series B (API 605) on request
Face to face dimension:	:	ANSI B16.10
BW connections	:	ANSI B16.25
NACE MR-01-75	:	On request
Shell test	:	450 p.s.i. (Hydrostatic)
Seat Test	:	315 p.s.i. (Hydrostatic). 80 p.s.i. (Air)
* Refer to the 'List of Standard materials'		



Gate WCB/F6 XU 150LBS RF

Art. No. (RF)	DN	L (RF)	L1 (BW)	L2 (RTJ)	H	W	Weight (RF)	Weight (BW)
120/20135	2"	178	216	191	409	200	20	17
120/20136	2.1/2"	190	241	203	472	200	30	26
120/20137	3"	203	283	216	532	250	36	29
120/20138	4"	229	305	241	612	250	53	46
120/20805	5"	254	381	267	710	300	71	66
120/20139	6"	267	403	279	806	300	85	77
120/20140	8"	292	419	305	990	350	136	116
120/20141	10"	330	457	343	1186	450	220	202
120/20248 (1)	12"	356	502	368	1405	500	323	294
120/20250	14"	381	572	394	1615	460 (2)	387	350
120/20251	16"	406	610	419	1811	460 (2)	553	506
120/20253	18"	432	660	445	1966	610 (2)	660	575
120/20254	20"	457	711	470	2210	610 (2)	810	720
120/20256	24"	508	813	521	2698	610 (2)	1250	1130
120/36045	28"	610	914	622	3030	610 (2)	1931	1765
120/20667	30"	610	914	622	3317	610 (2)	2380	2028
120/36046	32"	660	965	673	3487	610 (2)	2490	2280
120/35770	36"	711	1016	724	3825	760 (2)	3600	3080

ANSI Cast Valves

Gate WCB/F6 U 150LBS RF

Art. No. (RF)	DN	L (RF)	L1 (BW)	L2 (RTJ)	H	W	Weight (RF)	Weight (BW)
120/20145	2"	178	216	191	409	200	20	17
120/20146	2.1/2"	190	241	203	472	200	30	26
120/20147	3"	203	283	216	532	250	36	29
120/20148	4"	229	305	241	612	250	53	46
120/36047	5"	254	381	267	710	300	71	66
120/20149	6"	267	403	279	806	300	85	77
120/20150	8"	292	419	305	990	350	136	116
120/20151	10"	330	457	343	1186	450	220	202
120/20257 (1)	12"	356	502	368	1405	500	323	294
120/20268	14"	381	572	394	1615	460 ⁽²⁾	387	350
120/20269	16"	406	610	419	1811	460 ⁽²⁾	553	506
120/34895	18"	432	660	445	1966	610 ⁽²⁾	660	575
120/20292	20"	457	711	470	2210	610 ⁽²⁾	810	720
120/20293	24"	508	813	521	2698	610 ⁽²⁾	1250	1130
120/36048	28"	610	914	622	3030	610 ⁽²⁾	1931	1765
120/36049	30"	610	914	622	3317	610 ⁽²⁾	2380	2028
120/36050	32"	660	965	673	3487	610 ⁽²⁾	2490	2280
120/36051	36"	711	1016	724	3825	760 ⁽²⁾	3600	3080

- (1) Gear operated. 'W' dimension is referred to a handwheel valve
- (2) Gear operated

Gate		Tipo : Class 300	
Carbon steel - Class 300 Bolted Bonnet - Flanges RF/RTJ & BW			
Applications: Valves used in Oil refining, Petrochemical, Chemical, Metallurgy, Paper making and Pharmaceutical industries			
<ul style="list-style-type: none"> * OS&Y * Rising stem * Flexible solid wedge * Bolted bonnet * Threaded or welded seat ring 			
Specifications			
Type	:	Class 300	
Material	:	Body :ASTM A216 WCB (*) Trim:F6 U, XU, etc.	
Construction	:	Body/bonnet gasket:Spirometallic St.steel/Graphite	
Flanged	:	API 600	
Face to face dimension:	:	2" up to 24" ANSI B16.5. 26" up to 30" acc. to ASME B16.47 series A (MSS SP-44). ASME B16.47 series B (API 605) on request	
BW connections	:	ANSI B16.10	
NACE MR-01-75	:	On request	
Shell test	:	1125 p.s.i. (Hydrostatic)	
Seat test	:	814 p.s.i. (Hydrostatic). 80 p.s.i. (Air)	
* Refer to the 'List of Standard materials'			

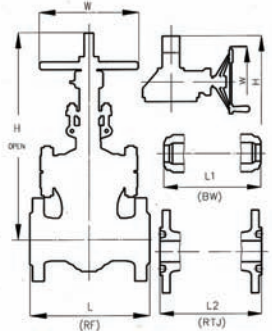

Gate WCB/F6 XU 300LBS RF

Art. No. (RF)	DN	L (RF) / L1 (BW)	L2 (RTJ)	H	W	Weight (RF)	Weight (BW)
120/20153	2"	216	232	400	200	30	26
120/20154	2.1/2"	241	257	477	250	39	34
120/20155	3"	283	298	543	250	55	47
120/20156	4"	305	321	650	300	83	68
120/35746	5"	381	397	770	300	92	77
120/20157	6"	403	419	880	350	137	118
120/20158	8"	419	435	1037	450	240	195
120/20159	10"	457	473	1275	500	333	271
120/20271 (1)	12"	502	518	1438	560	536	432
120/20665	14"	762	778	1650	460 (2)	699	595
120/20339	16"	838	854	1840	460 (2)	1010	848
120/20329	18"	914	930	2030	610 (2)	1205	1025
120/34853	20"	991	1010	2240	610 (2)	1720	1460
120/35303	24"	1143	1165	2900	610 (2)	2800	2294
120/36052	30"	1397	1422	3540	760 (2)	3786	3220

ANSI Cast Valves

Gate WCB/F6 U 300LBS RF

Art. No. (RF)	DN	L (RF) / L1 (BW)	L2 (RTJ)	H	W	Weight (RF)	Weight (BW)
120/20160	2"	216	232	400	200	30	26
120/20161	2.1/2"	241	257	477	250	39	34
120/20162	3"	283	298	543	250	55	47
120/20163	4"	305	321	650	300	83	68
120/36053	5"	381	397	770	300	92	77
120/20164	6"	403	419	880	350	137	118
120/20266	8"	419	435	1037	450	240	195
120/20270	10"	457	473	1275	500	333	271
120/20294 (1)	12"	502	518	1438	560	536	432
120/20881	14"	762	778	1650	460 (2)	699	595
120/20882	16"	838	854	1840	460 (2)	1010	848
120/20666	18"	914	930	2030	610 (2)	1205	1025
120/34984	20"	991	1010	2240	610 (2)	1720	1460
120/35472	24"	1143	1165	2900	610 (2)	2800	2294
120/36054	30"	1397	1422	3540	760 (2)	3786	3220

- (1) Gear operated. 'W' dimension belongs to a handwheel valve

- (2) Gear operated

Gate	Typo : Class 600
Carbon steel - Class 600 Bolted bonnet -Flanges RF/RTJ & BW	
Applications: Valves used in Oil refining, Petrochemical, Chemical, Metallurgy, Paper making and Pharmaceutical industries	
<ul style="list-style-type: none"> * OS&Y * Rising stem * Flexible solid wedge * Bolted bonnet * Threaded or welded seat ring 	
Specifications	
Type	: Class 600
Material	: Body :ASTM A216 WCB (*) Trim:F6 U, XU, etc. Body/bonnet gasket:Spirometallic Stainless steel/Graphite
Construction	: API 600
Flanged	: 2" up to 24" ANSI B16.5
Face to face dimension:	ANSI B16.10
BW Connections	: ANSI B16.25
NACE MR-01-75	: On request
Shell test	: 2225 p.s.i. (Hydrostatic)
Seat test	: 1628 p.s.i. (Hydrostatic). 80 p.s.i. (Air)
* Refer to the 'List of Standard materials'	

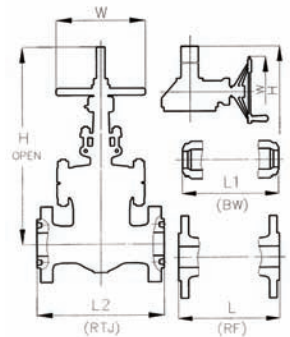

Gate WCB/F6 XU 600LBS RF

Art. No. (RF)	DN	L (RF) / L1 (BW)	L2 (RTJ)	H	W	Weight (RF)	Weight (BW)
120/20165	2"	292	295	474	250	41	35
120/35660	2.1/2"	330	333	553	250	58	50
120/20166	3"	356	359	593	300	88	68
120/20167	4"	432	435	713	350	131	104
120/20168	6"	559	562	970	500	253	208
120/20265	8"	660	664	1122	560	413	328
120/20296 (1)	10"	787	794	1330	720	623	496
120/20602	12"	838	841	1519	610 (2)	784	637
120/21275	14"	889	892	1730	610 (2)	1288	1120
120/35049	16"	991	994	1835	610 (2)	1820	1448
120/36055	18"	1092	1095	2290	610 (2)	2150	1828
120/34932	20"	1194	1200	2510	760 (2)	2540	2201
120/36056	24"	1397	1407	3022	760 (2)	4080	3360

Gate WCB/F6 U 600LBS RF

Art. No. (RF)	DN	L (RF) / L1 (BW)	L2 (RTJ)	H	W	Weight (RF)	Weight (BW)
120/20242	2"	292	295	474	250	41	35
120/35663	2.1/2"	330	333	553	250	58	50
120/20243	3"	356	359	593	300	88	68
120/20260	4"	432	435	713	350	131	104
120/20224	6"	559	562	970	500	253	208

ANSI Cast Valves

Art. No. (RF)	DN	L (RF) / L1 (BW)	L2 (RTJ)	H	W	Weight (RF)	Weight (BW)
120/20225	8"	660	664	1122	560	413	328
120/20297 (1)	10"	787	794	1330	720	623	496
120/20295	12"	838	841	1519	610 (2)	784	637
120/20370	14"	889	892	1730	610 (2)	1288	1120
120/35225	16"	991	994	1835	610 (2)	1820	1448
120/36057	18"	1092	1095	2290	610 (2)	2150	1828
120/36058	20"	1194	1200	2510	760 (2)	2540	2201
120/36059	24"	1397	1407	3022	760 (2)	4080	3360

- (1) Gear operated. 'W' dimension refers to a handwheel valve
- (2) Gear operated

Gate	Tipó : Class 900
Carbon steel - Class 900 Bolted bonnet - Flanged RF/RTJ & BW	
Applications: Valves used in Oil refining, Petrochemical, Chemical, Metallurgy, Paper making and Pharmaceutical industries	
<ul style="list-style-type: none"> * OS&Y * Rising stem * Flexible solid wedge * Bolted bonnet * Threaded or welded seat ring 	
Specifications	
Type	: Class 900
Material	: Body :ASTM A216 WCB (*) Trim:F6 U, XU, etc. Body/bonnet gasket:Spirometallic Stainless steel/Graphite
Construction	: API 600
Flanged	: 2" up to 16" ANSI B16.5
Face to face dimension	:ANSI B16.10
BW Connections	: ANSI B16.25
NACE MR-01-75	: On request
Shell test	: 3350 p.s.i. (Hydrostatic)
Seat test	: 2442 p.s.i. (Hydrostatic). 80 p.s.i. (Air)
* Refer to the 'List of Standard materials'	

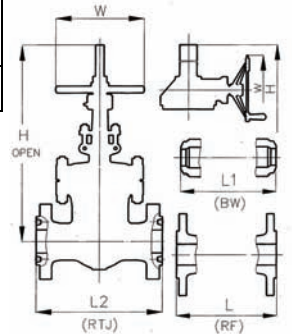

Gate WCB/F6 XU 900LBS RF

Art. No. (RF)	DN	L (RF) / L1 (BW)	L2 (RTJ)	H	W	Weight (RF)	Weight (BW)
120/36060	2"	368	371	547	300	90	82
120/36061	2.1/2"	419	422	700	355	110	93
120/21276	3"	381	384	648	400	123	108
120/21277	4"	457	460	729	450	148	122
120/21002	6"	610	613	1041	560	420	359
120/21003	8"	737	740	1260	460 ⁽¹⁾	650	566
120/36062	10"	838	841	1590	610 ⁽¹⁾	1160	980
120/36063	12"	965	968	1795	610 ⁽¹⁾	1700	1450
120/35980	14"	1029	1038	2025	760 ⁽¹⁾	2300	2000
120/36064	16"	1130	1140	2170	760 ⁽¹⁾	2750	2390

Gate WCB/F6 U 900LBS RF

Art. No. (RF)	DN	L (RF) / L1 (BW)	L2 (RTJ)	H	W	Weight (RF)	Weight (BW)
120/36065	2"	368	371	547	300	90	82
120/36066	2.1/2"	419	422	700	355	110	93
120/36067	3"	381	384	648	400	123	108
120/36068	4"	457	460	729	450	148	122
120/36069	6"	610	613	1041	560	420	359
120/36070	8"	737	740	1260	460 ⁽¹⁾	650	566

ANSI Cast Valves

Art. No. (RF)	DN	L (RF) / L1 (BW)	L2 (RTJ)	H	W	Weight (RF)	Weight (BW)
120/36071	10"	838	841	1590	610 ⁽¹⁾	1160	980
120/36072	12"	965	968	1795	610 ⁽¹⁾	1700	1450
120/36073	14"	1029	1038	2025	760 ⁽¹⁾	2300	2000
120/36074	16"	1130	1140	2170	760 ⁽¹⁾	2750	2390

- ⁽¹⁾ Gear operated

Gate		Tipo : Class 1500	
Carbon steel - Class 1500 Bolted bonnet - Flanged RF/RTJ & BW			
Applications: Valves used in Oil refining, Petrochemical, Chemical, Metallurgy, Paper making and Pharmaceutical industries			
<ul style="list-style-type: none"> * OS&Y * Rising stem * Flexible solid wedge * Bolted bonnet * Threaded or welded seat ring 			
Specifications			
Type	:	Class 1500	
Material	:	Body :ASTM A216 WCB (*) Trim:F6 U, XU, etc.	
Construction	:	Body/bonnet gasket:Spirometallic Stainless steel/Graphite	
Flanged	:	API 600	
Face to face dimension	:	2" up to 16" ANSI B16.5	
BW connections	:	ANSI B16.25	
NACE MR-01-75	:	On request	
Shell test	:	5575 p.s.i. (Hydrostatic)	
Seat test	:	4078 p.s.i. (Hydrostatic). 80 p.s.i. (Air)	
* Refer to the 'List of Standard materials'			

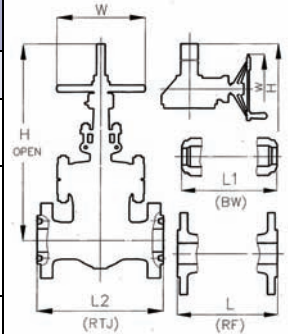

Gate WCB/F6 XU 1500LBS RF

Art. No. (RF)	DN	L (RF) / L1 (BW)	L2 (RTJ)	H	W	Weight (RF)	Weight (BW)
120/21004	2"	368	371	574	350	117	93
120/36075	2.1/2"	419	422	700	400	175	144
120/36076	3"	470	473	806	450	240	185
120/34942	4"	546	549	887	560	337	285
120/36100	6"	705	711	1079	305 ⁽¹⁾	680	584
120/36101	8"	832	841	1370	610 ⁽¹⁾	1228	978
120/36102	10"	991	1000	1520	760 ⁽¹⁾	2278	1990
120/36103	12"	1130	1146	1651	760 ⁽¹⁾	3260	2850
120/36104	14"	1257	1276	1945	760 ⁽¹⁾	4100	3320
120/36105	16"	1384	1407	2250	760 ⁽¹⁾	5960	4890

Gate WCB/F6 U 1500LBS RF

Art. No. (RF)	DN	L (RF) / L1 (BW)	L2 (RTJ)	H	W	Weight (RF)	Weight (BW)
120/36077	2"	368	371	574	350	117	93
120/36078	2.1/2"	419	422	700	400	175	144
120/35362	3"	470	473	806	450	240	185
120/36079	4"	546	549	887	560	337	285
120/36080	6"	705	711	1079	305 ⁽¹⁾	680	584
120/36081	8"	832	841	1370	610 ⁽¹⁾	1228	978
120/36082	10"	991	1000	1520	760 ⁽¹⁾	2278	1990
120/36083	12"	1130	1146	1651	760 ⁽¹⁾	3260	2850
120/36084	14"	1257	1276	1945	760 ⁽¹⁾	4100	3320
120/36085	16"	1384	1407	2250	760 ⁽¹⁾	5960	4890

- ⁽¹⁾ Gear operated

ANSI Cast Valves

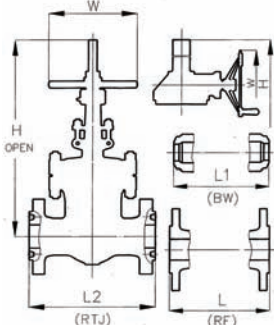

Gate	Tipo : Class 2500
Carbon steel - Class 2500LBS Bolted bonnet - Flanged RF/RTJ & BW	
Applications: Valves used in Oil refining, Petrochemical, Chemical, Metallurgy, Paper making and Pharmaceutical industries	
<ul style="list-style-type: none"> * OS&Y * Rising stem * Flexible solid wedge * Bolted bonnet * Threaded or welded seat ring 	
Specifications	
Type	: Class 2500
Material	: Body :ASTM A216 WCB (*) Trim:F6 U, XU, etc. Body/bonnet gasket:Spimetallc Stainless steel/Graphite
Construction	: API 600
Flanged	: 2" up to 10" ANSI B16.5
Face to face dimension:	ANSI B16.10
BW connections	: ANSI B16.25
NACE MR-01-75	: On request
Shell test	: 9275 p.s.i. (Hydrostatic)
Seat test	: 6787 p.s.i. (Hydrostatic). 80 p.s.i. (Air)
* Refer to the 'List of Standard materials'	

Gate WCB/F6 XU 2500LBS RF

Art. No. (RF)	DN	L (RF) / L1 (BW)	L2 (RTJ)	H	W	Weight (RF)	Weight (BW)
120/36086	2"	451	454	700	350	132	99
120/36087	2.1/2"	508	514	750	450	206	155
120/36088	3"	578	584	887	560	256	192
120/36089	4"	673	683	1079	720	498	390
120/36090	6"	914	927	1370	460 ⁽¹⁾	1550	1230
120/36091	8"	1022	1038	1530	610 ⁽¹⁾	2395	1980
120/36092	10"	1270	1292	2045	760 ⁽¹⁾	4460	3700

Gate WCB/F6 U 2500LBS RF

Art. No. (RF)	DN	L (RF) / L1 (BW)	L2 (RTJ)	H	W	Weight (RF)	Weight (BW)
120/36093	2"	451	454	700	350	132	99
120/36094	2.1/2"	508	514	750	450	206	155
120/36095	3"	578	584	887	560	256	192
120/36096	4"	673	683	1079	720	498	390
120/36097	6"	914	927	1370	460 ⁽¹⁾	1550	1230
120/36098	8"	1022	1038	1530	610 ⁽¹⁾	2395	1980
120/36099	10"	1270	1292	2045	760 ⁽¹⁾	4460	3700

- ⁽¹⁾ Gear operated

Gate	Typo : Class 150
Stainless steel - Class 150 Bolted bonnet - Flanged RF/RTJ & BW	
Applications: Valves used in Oil refining, Petrochemical, Chemical, Metallurgy, Paper making and Pharmaceutical industries	
<ul style="list-style-type: none"> * OS&Y * Rising stem * Flexible solid wedge * Bolted bonnet * Threaded or welded seat ring 	
Specifications	
Type	: Class 150
Material	: Body :ASTM A351 CF8M Trim:316 Body/bonnet gasket:Graphite
Construction	: API 603
Flanged	: 2" up to 24" ANSI B16.5. 26" up to 36" según ASME B16.47 series A (MSS SP-44). ASME B16.47 series B (API 605) on request
Face to face dimension:	ANSI B16.10
BW connections	: ANSI B16.25
NACE MR-01-75	: On request
Shell test	: 425 p.s.i. (Hydrostatic)
Seat test	: 303 p.s.i. (Hydrostatic). 80 p.s.i. (Air)
*	

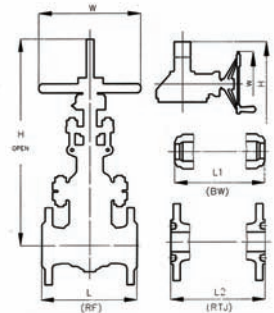

Gate CF8M/316 150LBS RF API 603

Art. No. (RF)	DN	L (RF)	L1 (BW)	L2 (RTJ)	H	W	Weight (RF)	Weight (BW)
122/03067	2"	178	216	191	409	200	20	17
122/04407	2.1/2"	190	241	203	472	200	30	26
122/03095	3"	203	283	216	532	250	36	29
122/03096	4"	229	305	241	612	250	53	46
122/04408	5"	254	381	267	710	300	71	66
122/03068	6"	267	403	279	806	300	85	77
122/03097	8"	292	419	305	990	350	136	116
122/04083	10"	330	457	343	1186	450	220	202
122/04115	12"	356	502	368	1405	500	323	294
122/03148	14"	381	572	394	1615	460 ⁽¹⁾	387	350
122/04409	16"	406	610	419	1811	460 ⁽¹⁾	553	506
122/04410	18"	432	660	445	1966	610 ⁽¹⁾	660	575
122/04411	20"	457	711	470	2210	610 ⁽¹⁾	810	720
122/04412	24"	508	813	521	2698	610 ⁽¹⁾	1250	1130
122/04413	28"	610	914	622	3030	610 ⁽¹⁾	1931	1765
122/04414	30"	610	914	622	3317	610 ⁽¹⁾	2380	2028
122/04415	32"	660	965	673	3487	610 ⁽¹⁾	2490	2280
122/04416	36"	711	1016	724	3825	760 ⁽¹⁾	3600	3080

ANSI Cast Valves

- ⁽¹⁾ Gear operated

Gate		Typo : Class 300
Stainless steel - Class 300 Bolted bonnet - Flanged RF/RTJ & BW		
Applications: Valves used in Oil refining, Petrochemical, Chemical, Metallurgy, Paper making and Pharmaceutical industries		
<ul style="list-style-type: none"> * OS&Y * Rising stem * Flexible solid wedge * Bolted bonnet * Threaded or welded seat ring 		
Specifications		
Type	:	Class 300
Material	:	Body :ASTM A351 CF8M Trim:316
Construction	:	Body/bonnet gasket:Spirometallic Stainless steel/Graphite API 600
Flanged	:	2" up to 24" ANSI B16.5. 26" up to 36" acc. to ASME B16.47 series A (MSS SP-44). ASME B16.47 series B (API 605) on request
Face to face dimension:	:	ANSI B16.10
BW connections	:	ANSI B16.25
NACE MR-01-75	:	On request
Shell test	:	1125 p.s.i. (Hydrostatic)
Seat test	:	814 p.s.i. (Hydrostatic). 80 p.s.i. (Air)
*		

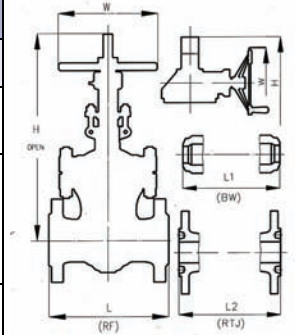

Gate CF8M/316 150LBS RF API 600

Art. No. (RF)	DN	L (RF) / L1 (BW)	L2 (RTJ)	H	W	Weight (RF)	Weight (BW)
122/03069	2"	216	232	400	200	30	26
122/04417	2.1/2"	241	257	477	250	39	34
122/03066	3"	283	298	543	250	55	47
122/03081	4"	305	321	650	300	83	68
122/04418	5"	381	397	770	300	92	77
122/03140	6"	403	419	880	350	137	118
122/04419	8"	419	435	1037	450	240	195
122/04420	10"	457	473	1275	500	333	271
122/04421	12"	502	518	1438	560	536	432
122/04422	14"	762	778	1650	460 ⁽¹⁾	699	595
122/04423	16"	838	854	1840	460 ⁽¹⁾	1010	848
122/04424	18"	914	930	2030	610 ⁽¹⁾	1205	1025
122/04425	20"	991	1010	2240	610 ⁽¹⁾	1720	1460
122/04426	24"	1143	1165	2900	610 ⁽¹⁾	2800	2294
122/04427	30"	1397	1422	3540	760 ⁽¹⁾	3786	3220

- ⁽¹⁾ Gear operated

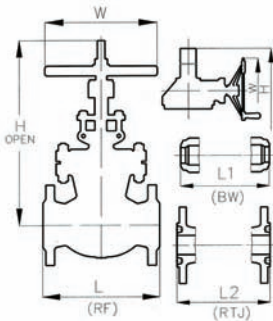

Globe		Tipo : Class 150
Carbon steel - Class 150 Bolted bonnet - Flanged RF/RTJ & BW		
Applications: Valves used in Oil refining, Petrochemical, Chemical, Metallurgy, Paper making and Pharmaceutical industries		
<ul style="list-style-type: none"> * OS&Y * Rising stem * Plug type disc * Bolted bonnet * Threaded seat ring 		
Specifications		
Type	:	Class 150
Material	:	Body :ASTM A216 WCB (*) Trim:F6 U, XU, etc. Body/bonnet gasket:Spirometallic Stainless steel/Graphite
Construction	:	BS 1873
Flanged	:	ASME B16.5
Face to face dimension:	:	ANSI B16.10
BW connections	:	ANSI B16.25
NACE MR-01-75	:	On request
Shell test	:	450 p.s.i. (Hydrostatic)
Seat test	:	315 p.s.i. (Hydrostatic). 80 p.s.i. (Air)
* Refer to the 'List of Standard materials'		

Globe WCB/F6 XU 150LBS RF

Art. No. (RF)	DN	L (RF) / L1 (BW)	L2 (RTJ)	H	W	Weight (RF)	Weight (BW)
130/14813	2"	203	216	373	200	22	19
130/14814	2.1/2"	216	229	390	250	29	25
130/14815	3"	241	254	421	250	42	34
130/14816	4"	292	305	515	300	64	49
130/15689	5"	356	368	538	300	77	65
130/14817	6"	406	419	567	350	105	82
130/14818	8"	495	508	626	400	154	131
130/18147	10"	622	635	712	450	288	249
130/18147 (1)	12"	698	711	990	610	507	430

Globe WCB/F6 U 150LBS RF

Art. No. (RF)	DN	L (RF) / L1 (BW)	L2 (RTJ)	H	W	Weight (RF)	Weight (BW)
130/14891	2"	203	216	373	200	22	19
130/14892	2.1/2"	216	229	390	250	29	25
130/14893	3"	241	254	421	250	42	34
130/14894	4"	292	305	515	300	64	49
130/18149	5"	356	368	538	300	77	65
130/14895	6"	406	419	567	350	105	82
130/14896	8"	495	508	626	400	154	131
130/14919	10"	622	635	712	450	288	249

Art. No. (RF)	DN	L (RF) / L1 (BW)	L2 (RTJ)	H	W	Weight (RF)	Weight (BW)
130/15921 (1)	12"	698	711	990	610	507	430

- (1) Gear operated. "W" dimension is referred to a handwheel valve

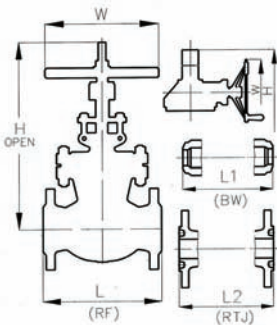

Globe		Typo : Class 300
Carbon steel - Class 300 Bolted bonnet - Flanged RF/RTJ & BW		
Applications: Valves used in Oil refining, Petrochemical, Chemical, Metallurgy, Paper making and Pharmaceutical industries		
<ul style="list-style-type: none"> * OS&Y * Rising stem * Plug type disc * Bolted bonnet * Threaded seat ring 		
Specifications		
Type	:	Class 300
Material	:	Body :ASTM A216 WCB (*) Trim:F6 U, XU, etc. Body/bonnet gasket:Spirometallic Stainless steel/Graphite
Construction	:	BS 1873
Flanged	:	ASME B16.5
Face to face dimension:	:	ANSI B16.10
BW connections	:	ANSI B16.25
NACE MR-01-75	:	On request
Shell test	:	1125 p.s.i. (Hydrostatic)
Seat test	:	814 p.s.i. (Hydrostatic). 80 p.s.i. (Air)
* Refer to the 'List of Standard materials'		

Globe WCB/F6 XU 300LBS RF

Art. No. (RF)	DN	L (RF) / L1 (BW)	L2 (RTJ)	H	W	Weight (RF)	Weight (BW)
130/14819	2"	267	283	398	200	31	26
130/15673	2.1/2"	292	308	436	250	43	38
130/14820	3"	318	333	462	250	57	44
130/14821	4"	356	371	560	350	86	68
130/17756	5"	400	416	620	400	130	110
130/14822	6"	444	460	694	450	168	138
130/15053	8"	559	575	982	560	280	228
130/15713	10"	622	638	1130	864	385	329
130/17881	12"	711	727	1049	460 ⁽²⁾	724	618

Globe WCB/F6 U 300LBS RF

Art. No. (RF)	DN	L (RF) / L1 (BW)	L2 (RTJ)	H	W	Weight (RF)	Weight (BW)
130/14897	2"	267	283	398	200	31	26
130/14898	2.1/2"	292	308	436	250	43	38
130/14899	3"	318	333	462	250	57	44
130/14900	4"	356	371	560	350	86	68
130/18244	5"	400	416	620	400	130	110
130/14901	6"	444	460	694	450	168	138
130/14920 ⁽¹⁾	8"	559	575	982	560	280	228
130/15015 ⁽¹⁾	10"	622	638	1130	864	385	329

ANSI Cast Valves

Art. No. (RF)	DN	L (RF) / L1 (BW)	L2 (RTJ)	H	W	Weight (RF)	Weight (BW)
130/18245	12"	711	727	1049	460 ⁽²⁾	724	618

- (1) Gear operated. 'W' is referred to a handwheel valve
- (2) Gear operated

ANSI Cast Valves

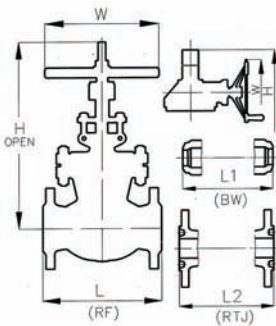

Globe	Tipo : Class 600
Carbon steel - Class 600 Bolted bonnet - Flanged RF/RTJ & BW	
Applications: Valves used in Oil refining, Petrochemical, Chemical, Metallurgy, Paper making and Pharmaceutical industries	
<ul style="list-style-type: none"> * OS&Y * Rising stem * Plug type disc * Bolted bonnet * Threaded seat ring 	
Specifications	
Type	: Class 600
Material	: Body :ASTM A216 WCB (*) Trim:F6 U, XU, etc. Body/bonnet gasket:Spirometallic Stainless steel/Graphite
ConstructiOn	: BS 1873
Flanged	: ASME B16.5
Face to face dimension:	: ANSI B16.10
BW connections	: ANSI B16.25
NACE MR-01-75	: On request
Shell test	: 2225 p.s.i. (Hydrostatic)
Seat test	: 1628 p.s.i. (Hydrostatic). 80 p.s.i. (Air)
* Refer to the 'List of Standard materials'	

Globe WCB/F6 XU 600LBS RF

Art. No. (RF)	DN	L (RF) / L1 (BW)	L2 (RTJ)	H	W	Weight (RF)	Weight (BW)
130/14858	2"	292	295	425	250	39	33
130/15680	2.1/2"	330	333	502	300	58	48
130/14859	3"	356	359	521	350	73	61
130/15001	4"	432	435	620	450	120	95
130/15011	6"	559	562	886	720	327	261
130/15922	8"	660	664	932	460 ⁽¹⁾	482	385
130/15049	10"	787	791	1040	610 ⁽¹⁾	700	588
130/18246	12"	838	841	1280	760 ⁽¹⁾	900	795

Globe WCB/F6 U 600LBS RF

Art. No. (RF)	DN	L (RF) / L1 (BW)	L2 (RTJ)	H	W	Weight (RF)	Weight (BW)
130/14889	2"	292	295	425	250	39	33
130/18085	2.1/2"	330	333	502	300	58	48
130/14903	3"	356	359	521	350	73	61
130/14838	4"	432	435	620	450	120	95
130/14983	6"	559	562	886	720	327	261
130/17846	8"	660	664	932	460 ⁽¹⁾	482	385
130/18247	10"	787	791	1040	610 ⁽¹⁾	700	588
130/18248	12"	838	841	1280	760 ⁽¹⁾	900	795

- ⁽¹⁾ Gear operated. 'W' dimension is referred to a handwheel valve

- (2) Gear operated

ANSI Cast Valves

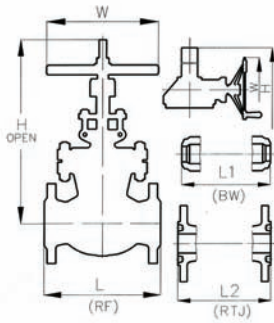

Globe		Tipo : Class 900
Carbon steel - Class 900 Bolted bonnet - Flanged RF/RTJ & BW		
Applications: Valves used in Oil refining, Petrochemical, Chemical, Metallurgy, Paper making and Pharmaceutical industries		
<ul style="list-style-type: none"> * OS&Y * Rising stem * Plug type disc * Bolted bonnet * Threaded seat ring 		
Specifications		
Type	:	Class 900
Material	:	Body :ASTM A216 WCB (*) Trim:F6 U, XU, etc. Body/bonnet gasket:Spimetallc Stainless steel/Graphite
Construction	:	BS 1873
Flanged	:	ASME B16.5
Face to face dimension:	:	ANSI B16.10
BW connections	:	ANSI B16.25
NACE MR-01-75	:	On request
Shell test	:	3350 p.s.i. (Hydrostatic)
Seat test	:	2442 p.s.i. (Hydrostatic). 80 p.s.i. (Air)
* Refer to the 'List of Standard materials'		

Globe WCB/F6 XU 900LBS RF

Art. No. (RF)	DN	L (RF) / L1 (BW)	L2 (RTJ)	H	W	Weight (RF)	Weight (BW)
130/18249	2"	368	371	620	350	99.3	75
130/18250	2.1/2"	-	-	-	-	-	-
130/15055	3"	381	384	665	400	112.2	105
130/15056	4"	457	460	813	450	148	185
130/15923	6"	610	613	1040	460 ⁽¹⁾	453	340
130/18251	8"	737	740	1200	460 ⁽¹⁾	515.2	630

Globe WCB/F6 U 900LBS RF

Art. No. (RF)	DN	L (RF) / L1 (BW)	L2 (RTJ)	H	W	Weight (RF)	Weight (BW)
130/18252	2"	368	371	620	350	99.3	75
130/18253	2.1/2"	-	-	-	-	-	94
130/18254	3"	381	384	665	400	112.2	105
130/18255	4"	457	460	813	450	148	185
130/18256	6"	610	613	1040	460 ⁽¹⁾	453	340
130/18257	8"	737	740	1200	460 ⁽¹⁾	515.2	630

- ⁽¹⁾ Gear operated

Globe		Tipo : Class 1500	
Carbon steel - Class 1500 Bolted bonnet - Flanged RF/RTJ & BW			
Applications: Valves used in Oil refining, Petrochemical, Chemical, Metallurgy, Paper making and Pharmaceutical industries			
<ul style="list-style-type: none"> * OS&Y * Rising stem * Plug type disc * Bolted bonnet * Threaded seat ring 			
Specifications			
Type	:	Class 1500	
Material	:	Body :ASTM A216 WCB (*) Trim:F6 U, XU, etc.	
Construction	:	Body/bonnet gasket:Spirometallic Stainless steel/Graphite	
Flanged	:	BS 1873	
Face to face dimension	:	ASME B16.5	
NACE MR-01-75	:	ANSI B16.10	
Shell test	:	ANSI B16.25	
Seat test	:	On request	
	:	5575 p.s.i. (Hydrostatic)	
	:	4078 p.s.i. (Hydrostatic). 80 p.s.i. (Air)	
* Refer to the 'List of Standard materials'			

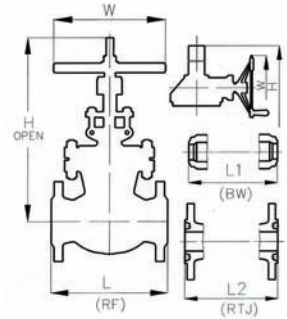

Globe WCB/F6 XU 1500LBS RF

Art. No. (RF)	DN	L (RF) / L1 (BW)	L2 (RTJ)	H	W	Weight (RF)	Weight (BW)
130/18258	2"	368	371	592	350	112	84
130/18259	2.1/2"	419	422	660	400	141	115
130/18260	3"	470	473	692	450	228	183
130/18261	4"	546	549	907	460 ⁽¹⁾	336	277
130/18262	6"	705	711	1015	610 ⁽¹⁾	822	715
130/18263	8"	832	841	1145	610 ⁽¹⁾	720	615

Globe WCB/F6 U 1500LBS RF

Art. No. (RF)	DN	L (RF) / L1 (BW)	L2 (RTJ)	H	W	Weight (RF)	Weight (BW)
130/18264	2"	368	371	592	350	112	84
130/18265	2.1/2"	419	422	660	400	141	115
130/18266	3"	470	473	692	450	228	183
130/18214	4"	546	549	907	460 ⁽¹⁾	336	277
130/18267	6"	705	711	1015	610 ⁽¹⁾	822	715
130/18268	8"	832	841	1145	610 ⁽¹⁾	720	615

- ⁽¹⁾ Gear operated

ANSI Cast Valves

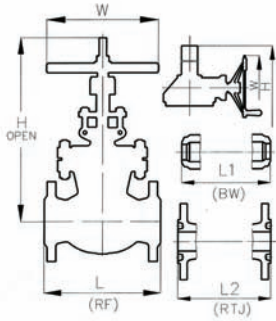

Globe		Tipó : Class 2500
Carbon steel - Class 2500 Bolted bonnet - Flanged RF/RTJ & BW		
Applications: Valves used in Oil refining, Petrochemical, Chemical, Metallurgy, Paper making and Pharmaceutical industries		
<ul style="list-style-type: none"> * OS&Y * Rising stem * Plug type disc * Bolted bonnet * Threaded seat ring 		
Specifications		
Type	:	Class 2500
Material	:	Body :ASTM A216 WCB (*) Trim:F6 U, XU, etc. Body/bonnet gasket:Spirometallic Stainless steel/Graphite
Construction	:	BS 1873
Flanged	:	ASME B16.5
Face to face dimension:	:	ANSI B16.10
BW connections	:	ANSI B16.25
NACE MR-01-75	:	On request
Shell test	:	9275 p.s.i. (Hydrostatic)
Seat test	:	6787 p.s.i. (Hydrostatic). 80 p.s.i. (Air)
* Refer to the 'List of Standard materials'		

Globe WCB/F6 XU 2500LBS RF

Art. No. (RF)	DN	L (RF) / L1 (BW)	L2 (RTJ)	H	W	Weight (RF)	Weight (BW)
130/18269	2"	451	454	692	400	182	153
130/18270	2.1/2"	508	514	750	500	290	230
130/18271	3"	578	584	800	610 ⁽¹⁾	340	272
130/18272	4"	673	683	1200	760 ⁽¹⁾	820	670

Globe WCB/F6 U 2500LBS RF

Art. No. (RF)	DN	L (RF) / L1 (BW)	L2 (RTJ)	H	W	Weight (RF)	Weight (BW)
130/18273	2"	451	454	692	400	182	153
130/18274	2.1/2"	508	514	750	500	290	230
130/18275	3"	578	584	800	610 ⁽¹⁾	340	272
130/18276	4"	673	683	1200	760 ⁽¹⁾	820	670

- ⁽¹⁾ Gear operated

Globe	Tipo : Class 150
Stainless steel - Class 150 Bolted bonnet - Flanged RF/RTJ & BW	
Applications: Valves used in Oil refining, Petrochemical, Chemical, Metallurgy, Paper making and Pharmaceutical industries	
<ul style="list-style-type: none"> * OS&Y * Rising stem * Plug type disc * Bolted bonnet * Threaded seat ring 	
Specifications	
Type	: Class 150
Material	: Body :ASTM A351 CF8M Trim:316 Body/bonnet gasket:Spirometallic Stainless steel/Graphite
Construction	: BS 1873
Flanged	: ASME B16.5
Face to face dimension	: ANSI B16.10
BW connections	: ANSI B16.25
NACE MR-01-75	: On request
Shell test	: 450 p.s.i. (Hydrostatic)
Seat test	: 315 p.s.i. (Hydrostatic). 80 p.s.i. (Air)
*	

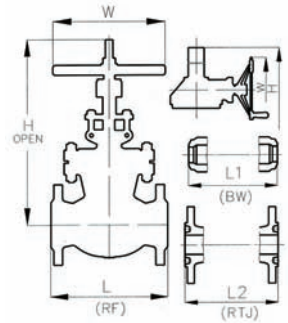

Globe CF8M/316 150LBS RF API 600

Art. No. (RF)	DN	L (RF) / L1 (BW)	L2 (RTJ)	H	W	Weight (RF)	Weight (BW)
132/01147	2"	203	216	373	200	22	19
132/02303	2.1/2"	216	229	390	250	29	25
132/01148	3"	241	254	421	250	42	34
132/01149	4"	292	305	515	300	64	49
132/02304	5"	356	368	538	300	77	65
132/01150	6"	406	419	567	350	105	82
132/02305	8"	495	508	626	400	154	131
132/02306	10"	622	635	712	450	288	249
132/02307	12"	698	711	990	610	507	430

- ⁽¹⁾ Gear operated. 'W' dimension is referred to a handwheel valve

ANSI Cast Valves

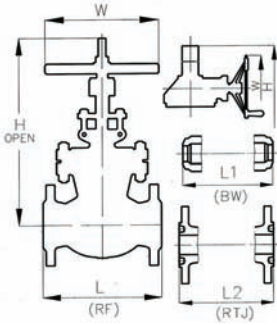

Globe		Tipo : Class 300	
Stainless steel - Class 300 Bolted bonnet - Flanged RF/RTJ & BW			
Applications: Valves used in Oil refining, Petrochemical, Chemical, Metallurgy, Paper making and Pharmaceutical industries			
<ul style="list-style-type: none"> * OS&Y * Rising stem * Plug type disc * Bolted bonnet * Threaded seat ring 			
Specifications			
Type	:	Class 300	
Material	:	Body :ASTM A351 CF8M	
		Trim:316	
		Body/bonnet gasket:Spimetallic Stainless steel/Graphite	
Construction	:	BS 1873	
Flanged	:	ASME B16.5	
Face to face dimension:	:	ANSI B16.10	
BW connections	:	ANSI B16.25	
NACE MR-01-75	:	On request	
Shell test	:	1125 p.s.i. (Hydrostatic)	
Seat test	:	825 p.s.i. (Hydrostatic). 80 p.s.i. (Air)	
*			

Globe CF8M/316 150LBS RF API 600

Art. No. (RF)	DN	L (RF) / L1 (BW)	L2 (RTJ)	H	W	Weight (RF)	Weight (BW)
132/01140	2"	267	283	398	200	31	26
132/02308	2.1/2"	292	308	436	250	43	38
132/01139	3"	318	333	462	250	57	44
132/02151	4"	356	371	560	350	86	68
132/02309	5"	400	416	620	400	130	110
132/02310	6"	444	460	694	450	168	138
132/02311	8"	559	575	982	560	280	228
132/02312	10"	622	638	1130	864	385	329
132/02313	12"	711	727	1049	460 ⁽¹⁾	724	618

- ⁽¹⁾ Gear operated

Swing Check		Tipó : Class 150
Carbon steel - Class 150 Bolted cover - Flanged RF/RTJ & BW		
Applications: Valves used in Oil refining, Petrochemical, Chemical, Metallurgy, Paper making and Pharmaceutical industries		
<ul style="list-style-type: none"> * Bolted cover * Swing type disc * Threaded or welded seat ring 		
Specifications		
Type	: Class 150	
Material	: Body :ASTM A216 WCB (*) Trim:F6 U, XU, etc. Body/cover gasket:Spirometallic Stainless steel/Graphite	
Construction	: BS 1868	
Flanged	: 2" up to 24" ANSI B16.5. 26" up to 36" acc. to ASME B16.47 series A (MSS SP-44). ASME B16.47 series B (API 605) on request	
Face to face dimension:	: ANSI B16.10	
BW connections	: ANSI B16.25	
NACE MR-01-75	: On request	
Shell test	: 450 p.s.i. (Hydrostatic)	
Seat test	: 315 p.s.i. (Hydrostatic).	
* Refer to the 'List of Standard materials'		

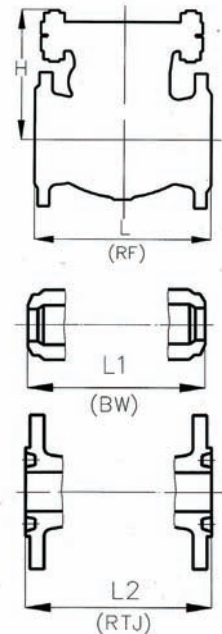

Swing Check WCB/F6 XU 150LBS RF

Art. No. (RF)	DN	L (RF) / L1 (BW)	L2 (RTJ)	H	Weight (RF)	Weight (BW)
140/15015	2"	203	216	150	17	13
140/14950	2.1/2"	216	229	168	21	17
140/15018	3"	241	254	180	29	24
140/15025	4"	292	305	210	42	36
140/16595	5"	330	343	230	69	57
140/15019	6"	356	368	275	74	62
140/14954	8"	495	508	340	108	96
140/15000	10"	622	635	355	177	158
140/15011	12"	698	711	410	282	238
140/15110	14"	787	800	475	372	324
140/15085	16"	864	876	552	570	483
140/15132	18"	978	991	600	665	548

ANSI Cast Valves

Art. No. (RF)	DN	L (RF) / L1 (BW)	L2 (RTJ)	H	Weight (RF)	Weight (BW)
140/16134	20"	978	991	660	900	782
140/16118	24"	1295	1308	740	1359	1150
140/16596	30"	1524	1537	980	2120	1890
140/16597	36"	1955	1968	1035	3344	2940

Swing Check WCB/F6 U 150LBS RF

Art. No. (RF)	DN	L (RF) / L1 (BW)	L2 (RTJ)	H	Weight (RF)	Weight (BW)
140/14985	2"	203	216	150	17	13
140/16449	2.1/2"	216	229	168	21	17
140/14986	3"	241	254	180	29	24
140/16058	4"	292	305	210	42	36
140/16598	5"	330	343	230	69	57
140/14987	6"	356	368	275	74	62
140/14988	8"	495	508	340	108	96
140/16450	10"	622	635	355	177	158
140/16059	12"	698	711	410	282	238
140/15082	14"	787	800	475	372	324
140/15216	16"	864	876	552	570	483
140/16599	18"	978	991	600	665	548
140/15217	20"	978	991	660	900	782
140/16600	24"	1295	1308	740	1359	1150
140/16601	30"	1524	1537	980	2120	1890
140/16602	36"	1955	1968	1035	3344	2940

Swing Check		Tipo : Class 300
Carbon steel - Class 300 Bolted cover - Flanged RF/RTJ & BW		
Applications: Valves used in Oil refining, Petrochemical, Chemical, Metallurgy, Paper making and Pharmaceutical industries		
<ul style="list-style-type: none"> * Bolted cover * Swing type disc * Threaded or welded seat ring 		
Specifications		
Type	: Class 300	
Material	: Body :ASTM A216 WCB (*) Trim:F6 U, XU, etc. Body/cover gasket:Spirometallic Stainless steel/Graphite	
Construction	: BS 1868	
Flanged	: 2" up to 24" ANSI B16.5. 26" up to 30" acc. to ASME B16.47 series A (MSS SP-44). ASME B16.47 series B (API 605) on request	
Face to face dimension:	: ANSI B16.10	
BW connections	: ANSI B16.25	
NACE MR-01-75	: On request	
Shell test	: 1125 p.s.i. (Hydrostatic)	
Seat test	: 814 p.s.i. (Hydrostatic).	
* Refer to the 'List of Standard materials'		

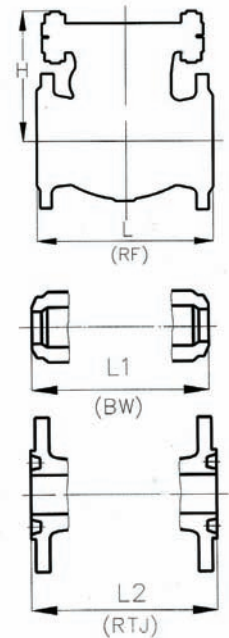

Swing Check WCB/F6 XU 300LBS RF

Art. No. (RF)	DN	L (RF) / L1 (BW)	L2 (RTJ)	H	Weight (RF)	Weight (BW)
140/15020	2"	267	283	180	21	16
140/15021	2.1/2"	292	308	185	32	24
140/15022	3"	318	333	210	43	35
140/15023	4"	356	371	270	61	44
140/16603	5"	400	416	345	84	61
140/15024	6"	444	460	360	131	105
140/15040	8"	533	549	370	213	167
140/15012	10"	622	638	385	384	272
140/15013	12"	711	727	440	449	375
140/15206	14"	838	854	520	680	560
140/16109	16"	864	879	554	840	710
140/16604	18"	978	994	590	1025	828
140/16605	20"	1016	1035	614	1320	1070
140/16606	24"	1346	1368	614	1960	1586

ANSI Cast Valves

Art. No. (RF)	DN	L (RF) / L1 (BW)	L2 (RTJ)	H	Weight (RF)	Weight (BW)
140/16607	30"	1594	1619	865	3270	2830

Swing Check WCB/F6 U 300LBS RF

Art. No. (RF)	DN	L (RF) / L1 (BW)	L2 (RTJ)	H	Weight (RF)	Weight (BW)
140/14989	2"	267	283	180	21	16
140/16608	2.1/2"	292	308	185	32	24
140/15078	3"	318	333	210	43	35
140/14979	4"	356	371	270	61	44
140/16609	5"	400	416	345	84	61
140/16610	6"	444	460	360	131	105
140/15083	8"	533	549	370	213	167
140/16611	10"	622	638	385	384	272
140/16551	12"	711	727	440	449	375
140/16612	14"	838	854	520	680	560
140/16613	16"	864	879	554	840	710
140/16614	18"	978	994	590	1025	828
140/16615	20"	1016	1035	614	1320	1070
140/16616	24"	1346	1368	614	1960	1586
140/16617	30"	1594	1619	865	3270	2830

Swing Check		Tipó : Class 600
Carbon steel - Class 600 Bolted cover - Flanged RF/RTJ & BW		
Applications: Valves used in Oil refining, Petrochemical, Chemical, Metallurgy, Paper making and Pharmaceutical industries		
<ul style="list-style-type: none"> * Bolted cover * Swing type disc * Threaded or welded seat ring 		
Specifications		
Type	: Class 600	
Material	: Body :ASTM A216 WCB (*) Trim:F6 U, XU, etc. Body/cover gasket:Spirometallic Stainless steel/Graphite	
Construction	: BS 1868	
Flanged	: ANSI B16.5	
Face to face dimension:	ANSI B16.10	
BW connections	: ANSI B16.25	
NACE MR-01-75	: On request	
Shell test	: 2225 p.s.i. (Hydrostatic)	
Seat test	: 1628 p.s.i. (Hydrostatic).	
* Refer to the 'List of Standard materials'		

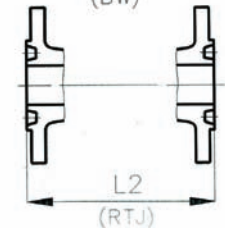
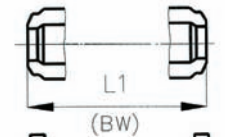
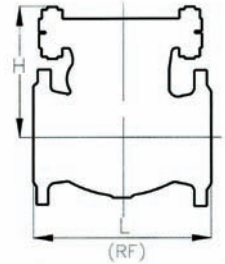

Swing Check WCB/F6 XU 600LBS RF

Art. No. (RF)	DN	L (RF) / L1 (BW)	L2 (RTJ)	H	Weight (RF)	Weight (BW)
140/14995	2"	292	295	197	36	28
140/15254	2.1/2"	330	333	207	49	40
140/14996	3"	356	359	231	68	57
140/14997	4"	432	435	281	111	83
140/15001	6"	559	562	362	230	191
140/15003	8"	660	664	437	416	361
140/15002	10"	787	791	490	673	543
140/16210	12"	838	841	528	875	770
140/16218	14"	889	892	572	944	773
140/16618	16"	991	994	660	1220	1015
140/16619	18"	1092	1095	720	1620	1350
140/16620	20"	1194	1200	746	2120	1750
140/16621	24"	1397	1407	960	3100	2520

ANSI Cast Valves

Swing Check WCB/F6 U 600LBS RF

Art. No. (RF)	DN	L (RF) / L1 (BW)	L2 (RTJ)	H	Weight (RF)	Weight (BW)
140/14991	2"	292	295	197	36	28
140/16622	2.1/2"	330	333	207	49	40
140/14992	3"	356	359	231	68	57
140/14993	4"	432	435	281	111	83
140/14980	6"	559	562	362	230	191
140/14981	8"	660	664	437	416	361
140/16623	10"	787	791	490	673	543
140/16624	12"	838	841	528	875	770
140/16625	14"	889	892	572	944	773
140/16626	16"	991	994	660	1220	1015
140/16627	18"	1092	1095	720	1620	1350
140/16628	20"	1194	1200	746	2120	1750
140/16629	24"	1397	1407	960	3100	2520

Swing Check		Tipo : Class 900	
Carbon steel - Class 900 Bolted cover - Flanged RF/RTJ & BW			
Applications: Valves used in Oil refining, Petrochemical, Chemical, Metallurgy, Paper making and Pharmaceutical industries			
* Bolted cover * Swing type disc * Threaded or welded seat ring			
Specifications			
Type	:	Class 900	
Material	:	Body :ASTM A216 WCB (*) Trim:F6 U, XU, etc. Body/cover gasket:Spirometallic Stainless steel/Graphite	
Construction	:	BS 1868	
Flanged	:	ANSI B16.5	
Face to face dimension:	ANSI B16.10		
BW connections	:	ANSI B16.25	
NACE MR-01-75	:	On request	
Shell test	:	3350 p.s.i. (Hydrostatic)	
Seat test	:	2442 p.s.i. (Hydrostatic).	
* Refer to the 'List of Standard materials'			

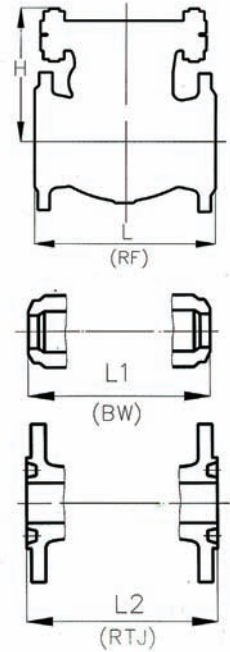

Swing Check WCB/F6 XU 900LBS RF

Art. No. (RF)	DN	L (RF) / L1 (BW)	L2 (RTJ)	H	Weight (RF)	Weight (BW)
140/16630	2"	368	371	240	69	52
140/16631	2.1/2"	419	422	260	93	74
140/16632	3"	381	384	260	91	70
140/16633	4"	457	460	320	145	112
140/16634	6"	610	613	382	259	218
140/16635	8"	737	740	530	565	448
140/16636	10"	838	841	560	900	733
140/16637	12"	965	968	590	1200	975
140/16638	14"	1029	1038	630	1500	1240
140/16639	16"	1130	1140	700	2130	1760

Swing Check WCB/F6 U 900LBS RF

Art. No. (RF)	DN	L (RF) / L1 (BW)	L2 (RTJ)	H	Weight (RF)	Weight (BW)
140/16640	2"	368	371	240	69	52
140/16641	2.1/2"	419	422	260	93	74
140/16642	3"	381	384	260	91	70
140/15278	4"	457	460	320	145	112
140/16643	6"	610	613	382	259	218
140/16644	8"	737	740	530	565	448
140/16645	10"	838	841	560	900	733
140/16646	12"	965	968	590	1200	975
140/16647	14"	1029	1038	630	1500	1240
140/16648	16"	1130	1140	700	2130	1760

ANSI Cast Valves

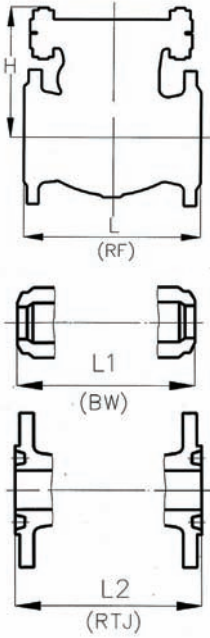

Swing Check		Tipó : Class 1500
Carbon steel - Class 1500 Bolted cover - Flanged RF/RTJ & BW		
Applications: Valves used in Oil refining, Petrochemical, Chemical, Metallurgy, Paper making and Pharmaceutical industries		
<ul style="list-style-type: none"> * Bolted cover * Swing type disc * Threaded or welded seat ring 		
Specifications		
Type	: Class 1500	
Material	: Body :ASTM A216 WCB (*) Trim:F6 U, XU, etc. Body/cover gasket:Spirometallic Stainless steel/Graphite	
Construction	: BS 1868	
Flanged	: ANSI B16.5	
Face to face dimension	:ANSI B16.10	
BW connections	: ANSI B16.25	
NACE MR-01-75	: On request	
Shell test	: 5575 p.s.i. (Hydrostatic)	
Seat test	: 4078 p.s.i. (Hydrostatic).	
* Refer to the 'List of Standard materials'		

Swing Check WCB/F6 XU 1500LBS RF

Art. No. (RF)	DN	L (RF) / L1 (BW)	L2 (RTJ)	H	Weight (RF)	Weight (BW)
140/16649	2"	368	371	310	69	49
140/16650	2.1/2"	419	422	310	93	74
140/16651	3"	470	473	330	140	111
140/16550	4"	546	549	355	232	185
140/16652	6"	705	711	400	490	375
140/16653	8"	832	841	530	990	803
140/16654	10"	991	1000	560	1490	1250
140/16655	12"	1130	1146	650	1970	1625
140/16656	14"	1257	1276			
140/16657	16"	1384	1407			

Swing Check WCB/F6 U 1500LBS RF

Art. No. (RF)	DN	L (RF) / L1 (BW)	L2 (RTJ)	H	Weight (RF)	Weight (BW)
140/16658	2"	368	371	310	69	49
140/16659	2.1/2"	419	422	310	93	74
140/16660	3"	470	473	330	140	111
140/16661	4"	546	549	355	232	185
140/16662	6"	705	711	400	490	375
140/16663	8"	832	841	530	990	803
140/16664	10"	991	1000	560	1490	1250
140/16665	12"	1130	1146	650	1970	1625
140/16666	14"	1257	1276			
140/16667	16"	1384	1407			

Swing Check		Tipo : Class 2500	
Carbon steel - Class 2500 Bolted cover - Flanged RF/RTJ & BW			
Applications: Valves used in Oil refining, Petrochemical, Chemical, Metallurgy, Paper making and Pharmaceutical industries			
<ul style="list-style-type: none"> * Bolted cover * Swing type disc * Threaded or welded seat ring 			
Specifications			
Type	:	Class 2500	
Material	:	Body :ASTM A216 WCB (*) Trim:F6 U, XU, etc. Body/cover gasket:Spirometallic Stainless steel/Graphite	
Construction	:	BS 1868	
Flanged	:	ANSI B16.5	
Face to face dimension:	:	ANSI B16.10	
BW connections	:	ANSI B16.25	
NACE MR-01-75	:	On request	
Shell test	:	9275 p.s.i. (Hydrostatic)	
Seat test	:	6787 p.s.i. (Hydrostatic).	
* Refer to the 'List of Standard materials'			

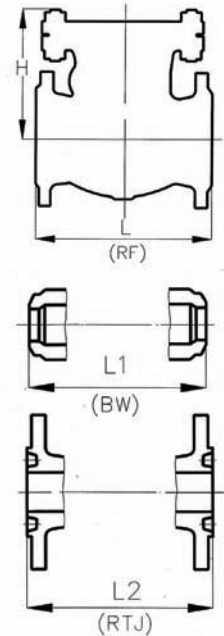

Swing Check WCB/F6 XU 2500LBS RF

Art. No. (RF)	DN	L (RF) / L1 (BW)	L2 (RTJ)	H	Weight (RF)	Weight (BW)
140/16668	2"	451	454	400	143	115
140/16669	2.1/2"	508	514	420	236	189
140/16670	3"	578	584	440	345	278
140/16671	4"	673	683	480	660	545
140/16672	6"	914	927	510	1435	1167
140/16673	8"	1022	1038	692	2485	2110

Swing Check WCB/F6 U 2500LBS RF

Art. No. (RF)	DN	L (RF) / L1 (BW)	L2 (RTJ)	H	Weight (RF)	Weight (BW)
140/16674	2"	451	454	400	143	115
140/16675	2.1/2"	508	514	420	236	189
140/16676	3"	578	584	440	345	278
140/16677	4"	673	683	480	660	545
140/16678	6"	914	927	510	1435	1167
140/16679	8"	1022	1038	692	2485	2110

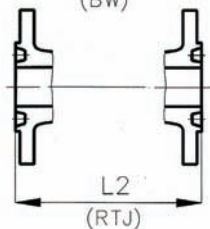
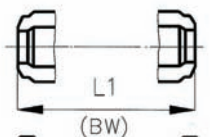
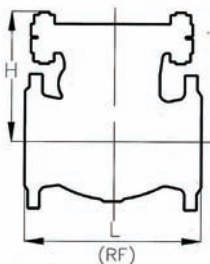

Swing Check		Tipo : Class 150
Stainless steel - Class 150 Bolted bonnet - Flanged RF/RTJ & BW		
Applications: Valves used in Oil refining, Petrochemical, Chemical, Metallurgy, Paper making and Pharmaceutical industries		
<ul style="list-style-type: none"> * Bolted cover * Swing type disc * Threaded or welded seat ring 		
Specifications		
Type	: Class 150	
Material	: Body :ASTM A351 CF8M Trim:316 Body/cover gasket:Spirometallic Stainless steel/Graphite	
Construction	: BS 1868	
Flanged	: 2" up to 24" ANSI B16.5. 26" up to 36" según ASME B16.47 series A (MSS SP-44). ASME B16.47 series B (API 605) on request	
Face to face dimension:	ANSI B16.10	
BW connections	: ANSI B16.25	
NACE MR-01-75	: OPn request	
Shell test	: 425 p.s.i. (Hidrostática)	
Seat test	: 303 p.s.i. (Hidrostática).	
*		

Swing Check CF8M/316 150LBS RF API 600

Art. No. (RF)	DN	L (RF) / L1 (BW)	L2 (RTJ)	H	Weight (RF)	Weight (BW)
142/01075	2"	203	216	150	17	13
142/03247	2.1/2"	216	229	168	21	17
142/01000	3"	241	254	180	29	24
142/01076	4"	292	305	210	42	36
142/03408	5"	330	343	230	69	57
142/01077	6"	356	368	275	74	62
142/01078	8"	495	508	340	108	96
142/03326	10"	622	635	355	177	158
142/03409	12"	698	711	410	282	238
142/03410	14"	787	800	475	372	324
142/03411	16"	864	876	552	570	483
142/03412	18"	978	991	600	665	548
142/03413	20"	978	991	660	900	782
142/03414	24"	1295	1308	740	1359	1150
142/03415	30"	1524	1537	980	2120	1890
142/03416	36"	1955	1968	1035	3344	2940

Swing Check		Tipo : Class 300
Stainless steel - Class 300 Bolted bonnet - Flanged RF/RTJ & BW		
Applications: Valves used in Oil refining, Petrochemical, Chemical, Metallurgy, Paper making and Pharmaceutical industries		
<ul style="list-style-type: none"> * Bolted cover * Swing type disc * Threaded or welded seat ring 		
Specifications		
Type	: Class 300	
Material	: Body :ASTM A351 CF8M Trim:316 Body/cover gasket:Spirometallic Stainless steel/Graphite	
Construction	: BS 1868	
Flanged	: 2" up to 24" ANSI B16.5. 26" up to 30" según ASME B16.47 series A (MSS SP-44). ASME B16.47 series B (API 605) on request	
Face to face dimension:	: ANSI B16.10	
BW connections	: ANSI B16.25	
NACE MR-01-75	: OPn request	
Shell test	: 1110 p.s.i. (Hidrostática)	
Seat test	: 792 p.s.i. (Hidrostática).	
*		

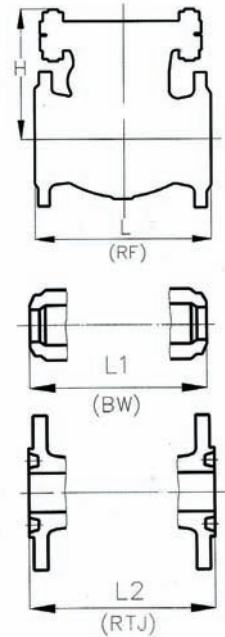

Swing Check CF8M/316 300LBS RF API 600

Art. No. (RF)	DN	L (RF) / L1 (BW)	L2 (RTJ)	H	Weight (RF)	Weight (BW)
142/03203	2"	267	283	180	21	16
142/03417	2.1/2"	292	308	185	32	24
142/01070	3"	318	333	210	43	35
142/03204	4"	356	371	270	61	44
142/03418	5"	400	416	345	84	61
142/01089	6"	444	460	360	131	105
142/03419	8"	533	549	370	213	167
142/03420	10"	622	638	385	384	272
142/03421	12"	711	727	440	449	375
142/03422	14"	838	854	520	680	560
142/03423	16"	864	879	554	840	710
142/03424	18"	978	994	590	1025	828
142/03425	20"	1016	1035	614	1320	1070
142/03426	24"	1346	1368	614	1960	1586
142/03427	30"	1594	1619	865	3270	2830

